

## Manufacturing Solutions For Couplers & Draft Gears

### Couplers



H-type coupler with long shank



H-type tight lock coupler for locomotive

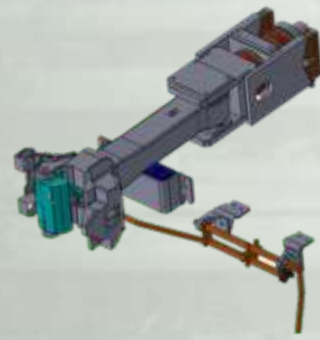

"H" type coupler assembly with balanced draft gear for LHB coaches



Semi permanent coupler



E-type transition coupler for locomotive



E-type transition coupler head with F-type shank for locomotive



E-type non transition coupler



Locomotive coupler assembly

### Draft Gears



WD -71 - BD -15 draft gear for freight rail car

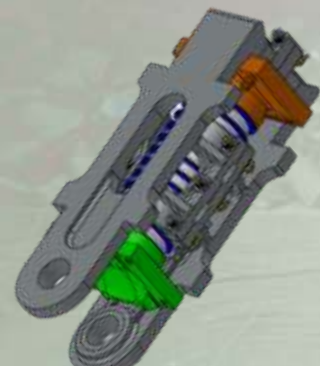

Soft draft gear for passenger locomotive

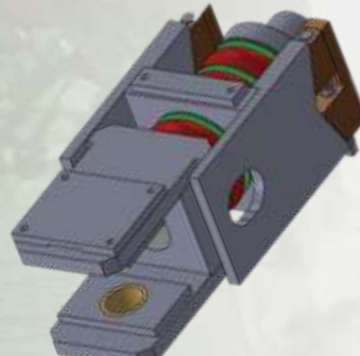

Balanced draft gear for passenger coaches



RF-361 draft gear for freight rail car

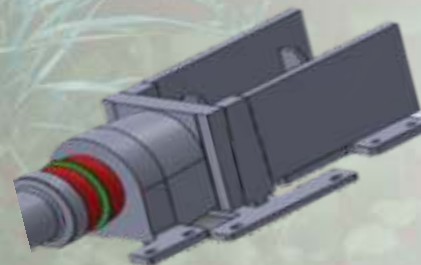

Semi permanent draft gear

## Our Credentials:



At BEC, we continue to strive to improve our product quality, processes, and ultimately, our customer satisfaction. The thread of this philosophy runs through our company where we strive to engineer and manufacture quality and performance into every product throughout all of our divisions.



Certified by  
**AAR, M-1003 (Association of American Railroads)**  
as per Quality Assurance Program as Specified in M-1003 for Manufacture of Locomotive Couplers, Yokes, Knuckles, Truck Frames, Bolsters, Draft Gear and Manufacturer of Frogs.



Certified by  
**TPG, USA (Transportation and Power Generation)** on the Qualified Manufacturers List (QML) for Castings.



Certified by the  
**Bureau Veritas**  
for Welding of Railway Vehicles & Components according to EN 15085-2:2020 + A1:2023.



Certified by  
**LRQA, UK**  
to the standards of ISO 9001:2015 for "Manufacturing and supply of all types of CASNUB Bogies for Freight Car Wagon, Truck Frame, Co-Co Bogies & Flexi Coil Bogies. All types of Couplers including E-types & H-types for Wagon and Locomotive, All types of Draft Gears including upgraded high capacity Draft Gear, Cast Manganese Steel Crossing, Wedges, Spring loaded side bearer assemblies and other castings made of Plain Carbon Steel, Cast Iron, SG Iron, Low alloy steel and High Manganese steel for railways and other industries up to unit cast weight of 10.5 T." and "Manufacture and sale of equipment's and machinery, steel plant, railways, mining, power plant, including fabrication, machining, and assembly of heavy structural / engineering components and others".



Certified by  
**LRQA, UK**  
to the standards of ISO - 14001 (Environment Management) and ISO - 45001 (OH&S)



Approved by  
**Bharat Locomotive Works, India**  
for the Manufacture & Supply of Truck Frame Assembly (EMD Pt. No. 40074880) used for HHP Locomotives.



Approved by  
**Chittaranjan Locomotive Works, India**  
for the Manufacture & Supply of Bogie Frame Assembly (Flexi-Coil Bogie) & Bolster for their WAP-4 Locomotives used by Indian Railways.



Our Foundry is Certified by the **Research Design & Standards Organization, India** as a Class "A" Foundry.



Approved by the  
**Research Design & Standards Organization, India**  
for the Manufacture & Supply of different Designs of Cast Manganese Steel Crossings to Indian Railways for their Track Infrastructure.

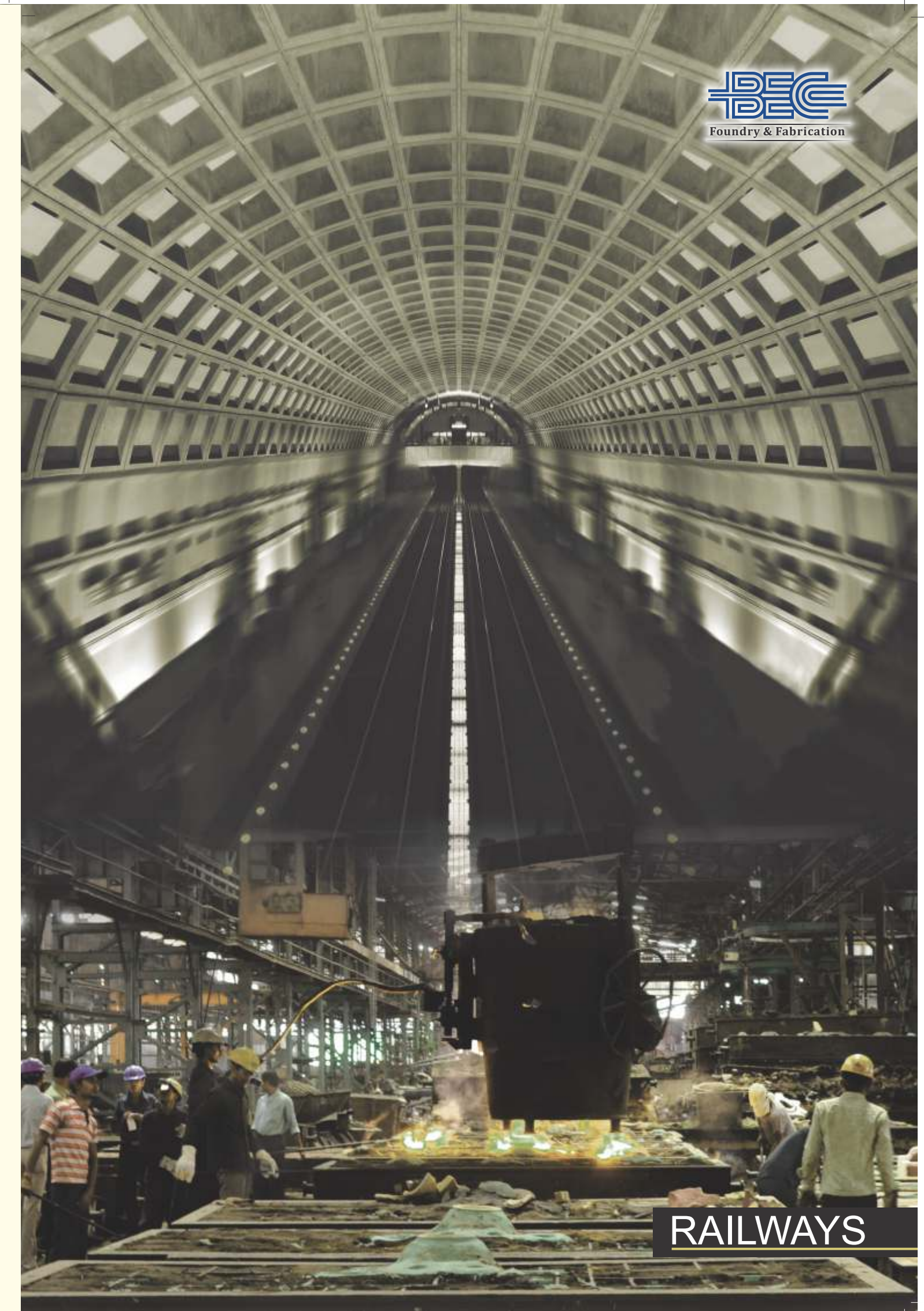

**RAILWAYS**

## Manufacturing Solutions For Advanced Bogie Frames

### Machined Under Frames / Bogies for Locomotive



- Cast Locomotive Bogie Frames for Tri Axle & Two Axle, Co-Co Bogie
- Flexi Coil Bogie & Truck Frames for Diesel Loco & Electric Loco

### Freight Car Bogie Parts & Assembly



- Cast Freight Car Bogies: Supply of Freight Bogie (Casnub) up to 25 Ton Axle load

### Fabricated Bogies



- Fabricated & Hybrid Bogie Frames for Locomotives, Coaches, Train Sets & Metro Cars

## Machined Parts supplied to Domestic & International Market

### Manufacturing Solutions For Track Crossings

#### High Manganese Machined Cast Steel Crossing, Inserts & Frogs

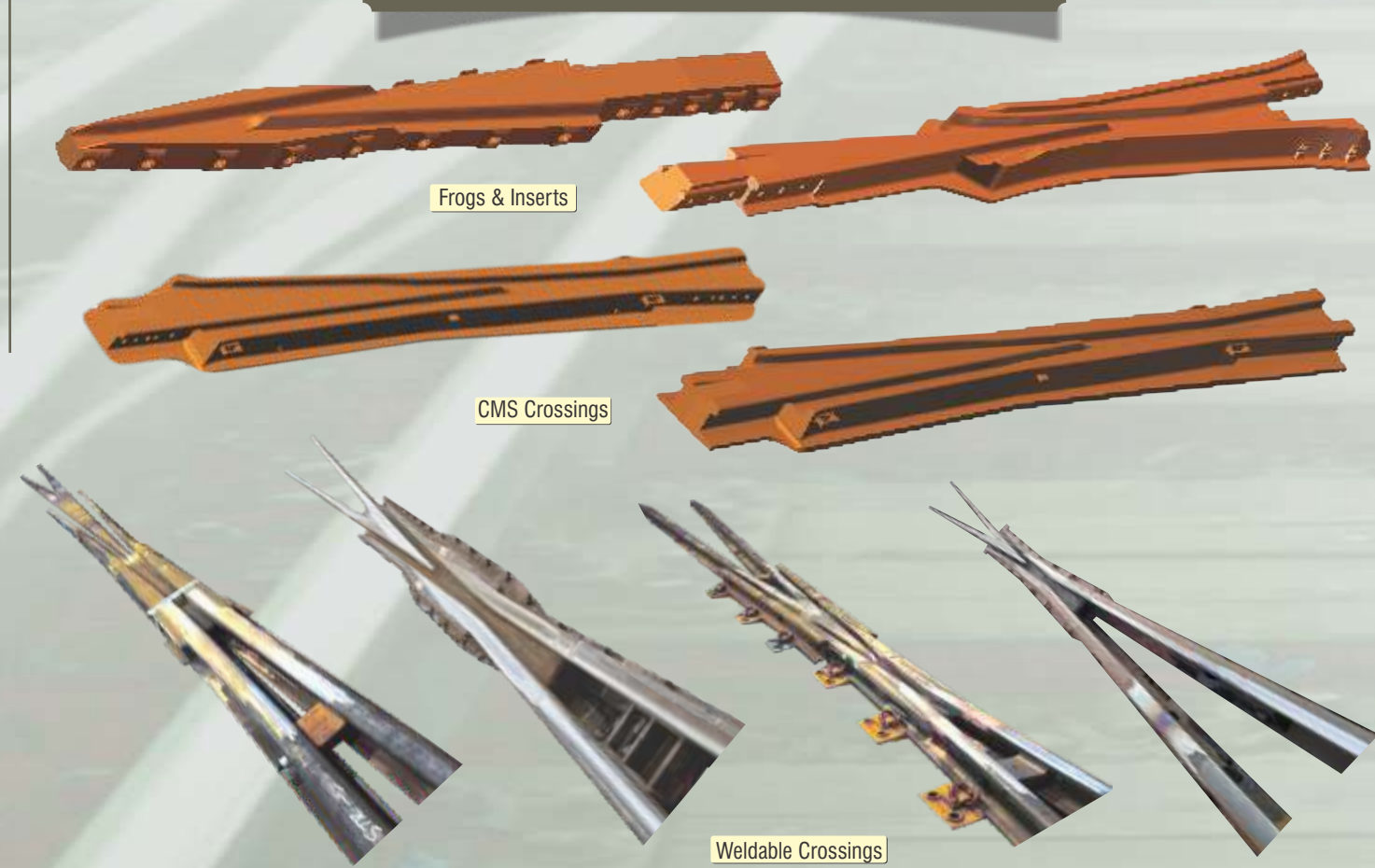

- Cast Mn-Steel Crossings for 52 Kg & 60 Kg Acute and Obtuse Crossings
- Mn-Steel Frogs & Inserts Bridge Joints, Weldable Crossings, Scissor & Diamond Crossings, EDH on Crossings

### Manufacturing Solutions For Extra-large Fabrications

#### Crankcase Cylinders - 8, 12, 16

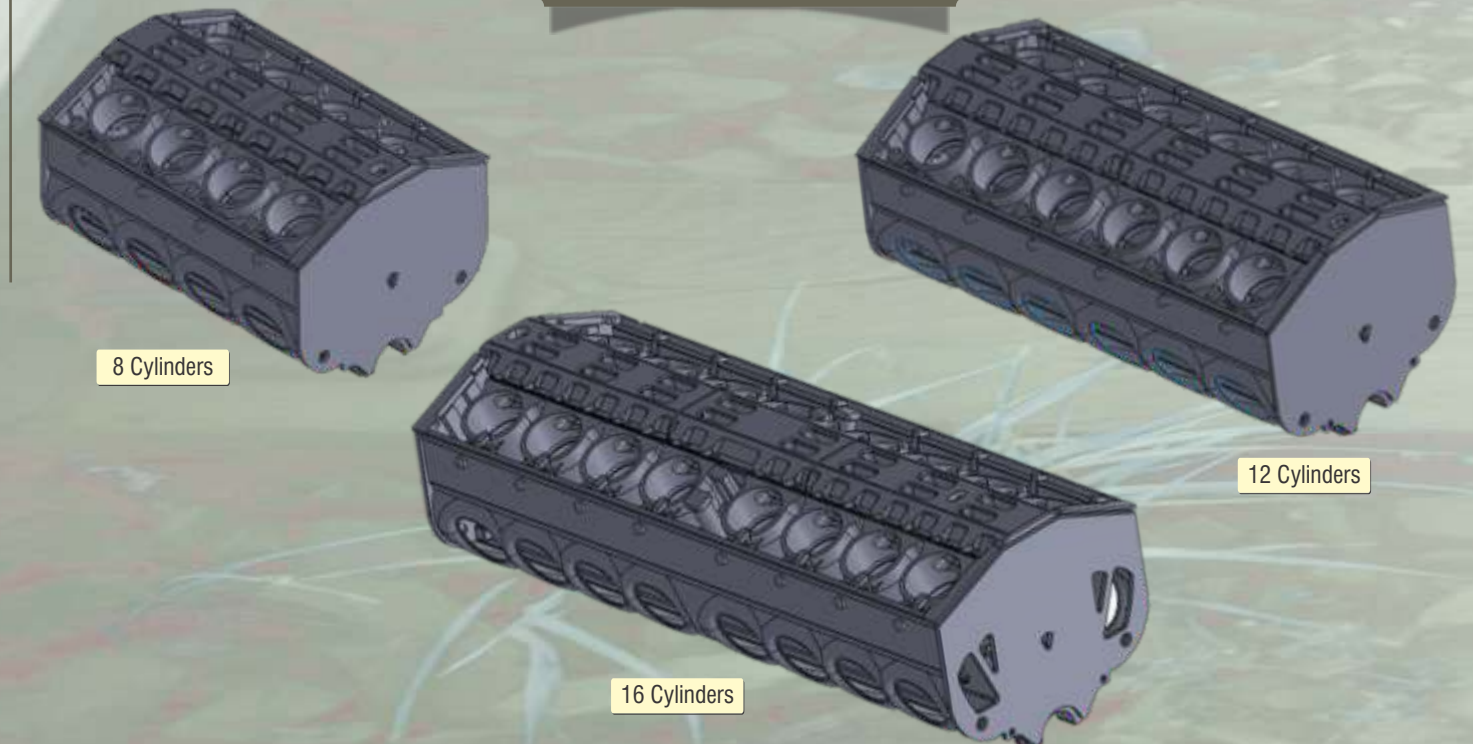

### Conglomerate Railway Machined Castings

#### Child Parts for Railway Machined Castings

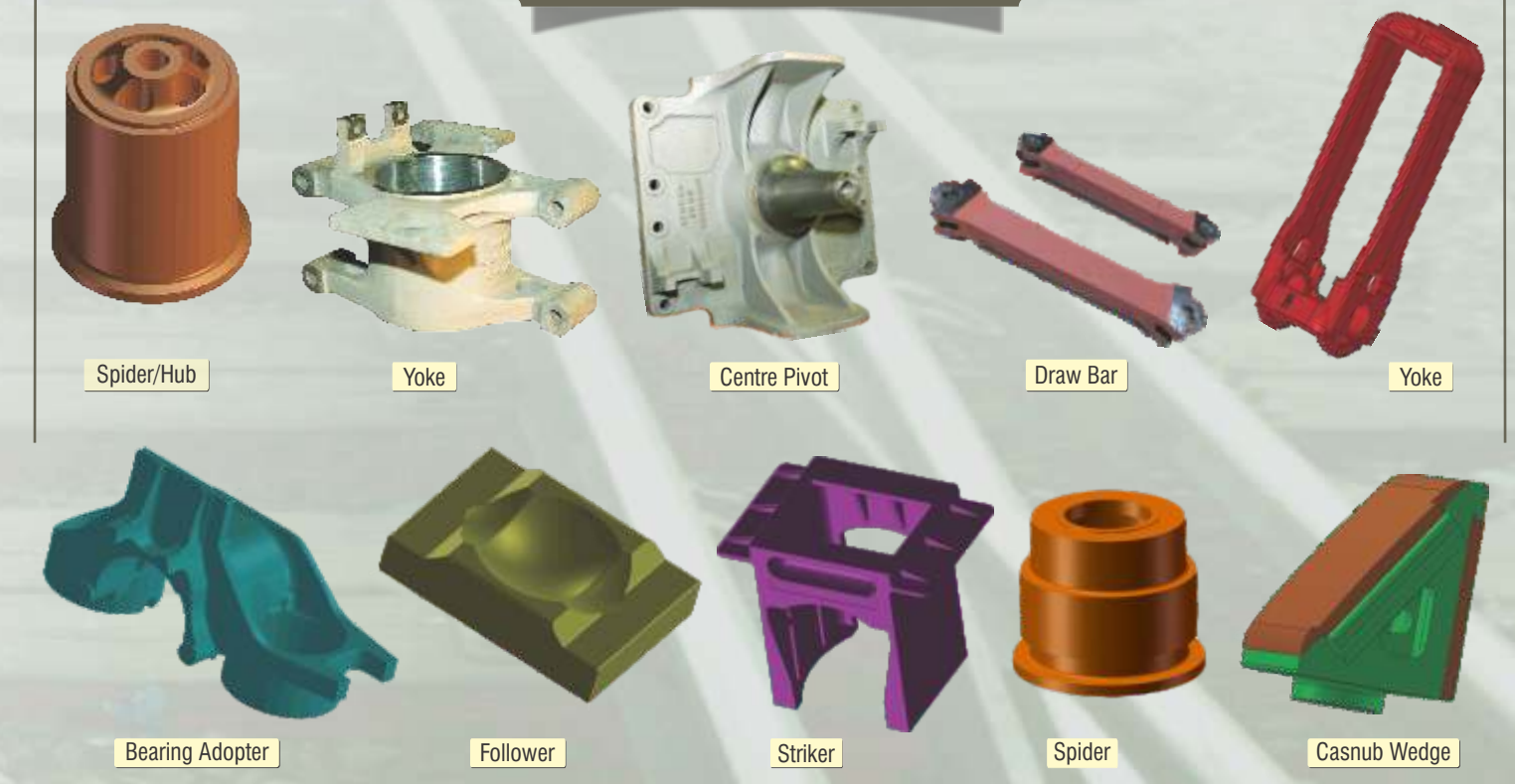

- Critical Cast Parts: Steel & Alloy cast parts in Machined conditions for Rolling Stock

#### Child Parts for Hybrid Bogie Frames

